

## INSTRUCCIONES DE MONTAJE DE BALUN 1,6/5,6 HEMBRA a CABLE DE PARES IDC 75-120 Ohm E1, E2, E3 – 2/8/34 Mbit/s APANTALLADO

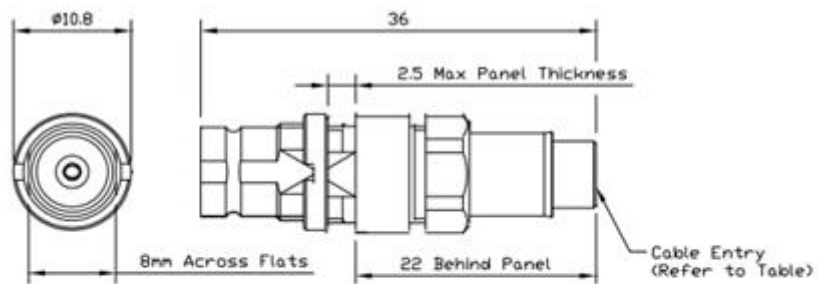

## Balun Terminating Procedure

1. Disassemble the rear end components from the balun.
2. Fit the rear outer cover assembly onto the cable, beginning with the small end.

3. Strip the cable jacket to 13mm from the end of the cable  
Cut the cable shield 6mm from the end of the cable.

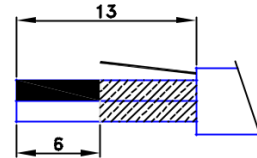

4. Flair the cable shield and fold it back over the sheath.
5. Insert the wires into the holes in the small end of the stuffer cap.

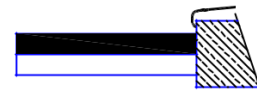

6. The hole in the raised section of the stuffer cap corresponds to the polarity of the centre conductor (tip) of the coaxial connector.

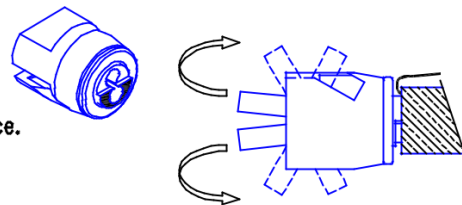

Ensure the stuffer cap is pushed hard against the cable face. Spread the conductors apart towards the sides of the stuffer cap and fit the conductor ends into the slot in each side of the stuffer cap.

7. Ensure that the end of each conductor is positioned behind the lip and into the cavity at the end of the slot as per the illustration.

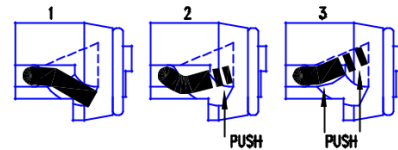

8. Fold the cable shield back over the outside of the stuffer cap. Ensure the drain wire ends within the tapered section of the stuffer cap.

9. Orient the tongue on the balun to line up with the flat on the stuffer cap and insert the stuffer cap onto the IDC terminals. Ensure that the wires are correctly positioned in the slots. (Refer to point 7 above)

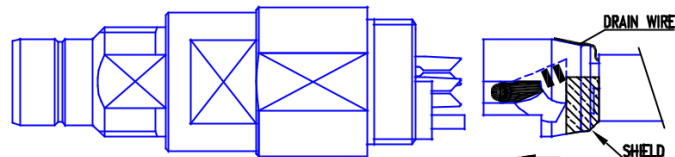

10. Pull the rear outer assembly forward and align the key to the key into the balun body. Secure the nut finger tight. Lightly tighten using a 10mm spanner. Do not over tighten as the cable shield may be damaged.

